

<input checked="" type="checkbox"/> PHOTOS TAKEN <input type="checkbox"/> OH2 <input checked="" type="checkbox"/> OH3 <input type="checkbox"/> SECONDARY CRASH <input type="checkbox"/> ON-HP <input type="checkbox"/> OTHER <input type="checkbox"/> Private Property		LOCAL INFORMATION <b>I-77 SB / 143 MM</b> REPORTING AGENCY NAME * <b>Richfield Police Department</b>		<b>2 0 2 4 0 7 1 2</b>	
COUNTY * <b>7 7</b>		LOCALITY * <b>2</b>		LOCATION: CITY, VILLAGE, TOWNSHIP * <b>RICHFIELD</b>	
ROUTE TYPE <b>I R</b>		ROUTE NUMBER <b>7 7</b>		PREFIX <b>2</b>	
ROUTE TYPE <b>H W</b>		ROUTE NUMBER <b>143.4</b>		PREFIX <b>4</b>	
REFERENCE POINT <b>2</b>		DIRECTION <b>1</b>		ROUTE TYPE <b>IR - INTERSTATE ROUTE (TP)</b>	
DISTANCE FROM REFERENCE <b>4 7 0</b>		DISTANCE EAST OF MEASURE <b>2</b>		ROAD TYPE <b>AL - ALLEY</b> <b>AV - AVENUE</b> <b>BL - BOULEVARD</b> <b>CR - CIRCLE</b> <b>CT - COURT</b> <b>DR - DRIVE</b> <b>HE - HEIGHTS</b>	
LOCATION OF FIRST HARMFUL EVENT <b>0 2</b>		MANNER OF CRASH COLLISION/IMPACT <b>1</b>		DIRECTION OF TRAVEL <b>2</b>	
WORK ZONE RELATED <input type="checkbox"/> WORKERS PRESENT <input type="checkbox"/> LAW ENFORCEMENT PRESENT <input type="checkbox"/> ACTIVE SCHOOL ZONE		WORK ZONE TYPE <b>2</b>		LOCATION OF CRASH IN WORK ZONE <b>4</b>	
LIGHT CONDITION <b>2</b>		WEATHER <b>4</b>		CONTOUR <b>1</b>	
CRASH REPORTED DATETIME <b>111062024 0659</b>		DISPATCH DATETIME <b>111062024 0704</b>		ARRIVAL DATETIME <b>111062024 0709</b>	
TOTAL TIME ROADWAY CLOSED <b>5 0</b>		OTHER INVESTIGATION TIME <b>6 0</b>		SCENE CLEARED DATETIME <b>111062024 0815</b>	
OFFICER'S NAME * <b>Brett Lee</b>		CHECKED BY OFFICER'S NAME <b>Thomas Randolph</b>		REPORT TAKEN BY <input checked="" type="checkbox"/> POLICE AGENCY <input type="checkbox"/> MOTORIST	
OFFICER'S BADGE NUMBER * <b>7 2 5</b>		CHECKED BY OFFICER'S BADGE NUMBER * <b>7 0 6</b>		<input type="checkbox"/> SUPPLEMENT (CORRECTION - ADDITION)	

NARRATIVE  
 UNIT 1 WAS TRAVELING SOUTHBOUND ON I-77. UNIT 1 WAS IN THE RIGHT-MOST LANE, AND BEGAN TO BE PRESSURED BY A SEMI IN THE MIDDLE LANE SWERVING INTO THE RIGHT-MOST LANE. UNIT 1 SWERVED TO AVOID A COLLISION AND STRUCK THE GUARD RAIL FACE, TRAVELING ALONG THE GUARD RAIL BODY, BEFORE COMING TO FINAL REST ON THE ROADWAY.

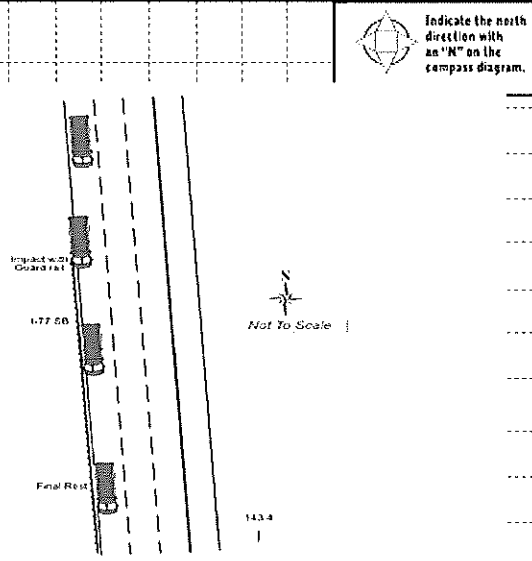

UNIT # 01 OWNER NAME: LAST, FIRST, MIDDLE ( ) Same As Driver  
**Electrical Connected** OWNER PHONE: INCLUDE AREA CODE ( ) Same As Driver  
 OWNER ADDRESS: STREET, CITY, STATE, ZIP ( ) Same As Driver  
**7160 Chagrin Rd 145 Chagrin Falls OH 44023**  
 COMMERCIAL CARRIER: NAME, ADDRESS, CITY, STATE, ZIP  
**Connected Electrical 7160 Chagrin Road Chagrin Falls OH** COMMERCIAL CARRIER PHONE: INCLUDE AREA CODE

LP STATE OH LICENSE PLATE # PLU5240 VEHICLE IDENTIFICATION # 3C6LRVAG5ME5618468 VEHICLE YEAR 2021 VEHICLE MAKE Dodge  
 INSURANCE VERIFIED INSURANCE COMPANY State Farm INSURANCE POLICY # 95G8E5479 VEHICLE COLOR WHI VEHICLE MODEL Ram  
 COMMERCIAL  GOVERNMENT  IN EMERGENCY RESPONSE US DOT # \_\_\_\_\_ TOWED BY: COMPANY NAME World Truck  
 INTERLOCK DEVICE EQUIPPED  HITSKIP UNIT # OCCUPANTS 01 VEHICLE WEIGHT GVWR/GCWR HAZARDOUS MATERIAL  
 1- <10K LBS. 2- 10,001 - 26K LBS. 3- >26K LBS.  MATERIAL RELEASED CLASS # PLACARD ID #  
 FLACARD

UNIT TYPE 05 # OF TRAILING UNITS 0  
 1- PASSENGER CAR 7- MOTORCYCLE 2-WHEELED 12- GOLF CART 18- LIMO (LIVERY VEHICLE) 23- PEDESTRIAN SKATER  
 2- PASSENGER VAN (MINIVAN) 8- MOTORCYCLE 3-WHEELED 13- SNOWMOBILE 19- BUS (16+ PASSENGERS) 24- WHEELCHAIR (ANY TYPE)  
 3- SPORT UTILITY VEHICLE 9- AUTOCYCLE 14- SINGLE UNIT TRUCK 20- OTHER VEHICLE 25- OTHER NON-MOTORIST  
 4- PICK UP 10- MOPED OR MOTORIZED BICYCLE 15- SEM-TRACTOR 21- HEAVY EQUIPMENT 26- BICYCLE  
 5- CARGO VAN 11- ALL TERRAIN VEHICLE (ATV/UTV) 16- FARM EQUIPMENT 22- ANIMAL WITH RIDER OR ANIMAL-DRAWN VEHICLE 27- TRAIN  
 6- VAN (9-15 SEATS) 17- MOTORHOME 59- UNKNOWN OR HITSKIP

WAS VEHICLE OPERATING IN AUTO/NOXIOUS MODE WHEN CRASH OCCURED? 0 0- NO AUTOVATION 1- DRIVER ASSISTANCE 2- PARTIAL AUTOVATION 3- CONDITIONAL AUTOVATION 4- HIGH AUTOVATION 5- FULL AUTOVATION 9- UNKNOWN

SPECIAL FUNCTION 01  
 1- NONE 2- TAXI 3- ELECTRONIC RIDE SHARING 4- SCHOOL TRANSPORT 5- BUS TRANSIT/COMPUTER 6- BUS-CHARTER/TOUR 7- BUS-INTERCITY 8- BUS-SHUTTLE 9- BUS-OTHER 10- AMBULANCE 11- FIRE 12- MILITARY 13- POLICE 14- PUBLIC UTILITY 15- CONSTRUCTION EQUIPMENT 16- FARM 17- MOWING 18- SNOW REMOVAL 19- TOWING 20- SAFETY SERVICE PATROL 21- MAIL CARRIER 22- OTHER UNKNOWN

CARGO BODY TYPE 06  
 1- NO CARGO BODY TYPE (NOT APPLICABLE) 2- BUS 3- VEHICLE TOWING ANOTHER MOTOR VEHICLE 4- LOGGING 5- INTERMODAL CONTAINER CHASSIS 6- CARGO VAN/ENCLOSED BOX 7- GRAIN CHASSIS/RAVEL 8- POLE 9- CARGO TANK 10- FLAT BED 11- DUMP 12- CONCRETE MIXER 13- AUTO TRANSPORTER 14- GARBAGE REFUSE 59- OTHER/UNKNOWN

VEHICLE DEFECTS  
 1- TURN SIGNALS 2- HEAD LAMPS 3- TAIL LAMPS 4- BRAKES 5- STEERING 6- TIRE BLOWOUT 7- WORN OR SLICK TIRES 8- TRAILER EQUIPMENT DEFECTIVE 9- MOTOR TROUBLE 10- DISABLED FROM PRIOR ACCIDENT 59- OTHER/UNKNOWN

NON-MOTORIST LOCATION AT IMPACT  
 1- INTERSECTION-MARKED CROSSWALK 2- INTERSECTION-UNMARKED 3- INTERSECTION-OTHER 4- MEDIAN-MARKED CROSSWALK 5- TRAVEL LANE-OTHER LOCATION 6- BICYCLE LANE 7- SHOULDER/ROADSIDE 8- SIDEWALK 9- MEDIAN/CROSSING ISLAND 10- DRIVEWAY ACCESS 11- SHARED USE PATHS OR TRAILS 12- FIRST RESPONDER AT INCIDENT SCENE 59- OTHER/UNKNOWN

ACTION 3 PRE-CRASH ACTION 01  
 1- NON-CONTACT 2- NON-COLLISION 3- STRIKING 4- STRUCK 5- BOTH STRIKING & STRUCK 9- OTHER/UNKNOWN 1- STRAIGHT AHEAD 2- BACKING 3- CHANGING LANES 4- OVERTAKING/PASSING 5- MAKING RIGHT TURN 6- MAKING LEFT TURN 7- MAKING U-TURN 8- ENTERING TRAFFIC LANE 9- LEAVING TRAFFIC LANE 10- PARKED 11- SLOWING OR STOPPED IN TRAFFIC 12- DRIVERLESS 13- NEGOTIATING A CURVE 14- ENTERING OR CROSSING SPECIFIED LOCATION 15- WALKING/RUNNING, JOGGING, PLAYING 16- WORKING 17- PUSHING VEHICLE 18- APPROACHING OR LEAVING VEHICLE 19- STANDING 20- OTHER NON-MOTORIST 21- STANDING OUTSIDE DISABLED VEHICLE 59- OTHER/UNKNOWN

CONTRIBUTING CIRCUMSTANCES 15  
 1- NONE 2- FAILURE TO YIELD 3- RAN RED LIGHT 4- RAN STOP SIGN 5- UNSAFE SPEED 6- IMPROPER TURN 7- LEFT OF CENTER 8- FOLLOWING TOO CLOSE/ACCID 9- IMPROPER LANE CHANGING 10- IMPROPER PASSING 11- DROVE OFF ROAD 12- IMPROPER BACKING 13- IMPROPER START FROM A PARKED POSITION 14- STOPPED OR PARKED ILLEGALLY 15- SWERVING TO AVOID 16- WRONG WAY 17- VISION OBSTRUCTION 18- OPERATING DEFECTIVE EQUIPMENT 19- LOAD SHIFTING/FALLING/SPILLING 20- IMPROPER CROSSING 21- LYING IN ROADWAY 22- NOT DISCRIBABLE 23- OPENING DOOR INTO ROADWAY 59- OTHER IMPROPER ACTION

SEQUENCE OF EVENTS  
108 1- OVERTURN/ROLLOVER 2- FIRE/EXPLOSION 3- INVERSION 4- JACKKNIFE 5- CARGO/EQUIPMENT LOSS OR SHIFT 6- EQUIPMENT FAILURE 7- SEPARATION OF UNITS 8- RAN OFF ROAD RIGHT 9- RAN OFF ROAD LEFT 10- CROSS MEDIAN 11- CROSS CENTERLINE - OPPOSITE DIRECTION OF TRAVEL 12- DOWNHILL RUNAWAY 13- OTHER NON-COLLISION 14- PEDESTRIAN 15- PEDALCYCLE 16- RAILWAY VEHICLE 17- ANIMAL - FARM 18- ANIMAL - DEER 19- ANIMAL - OTHER 20- MOTOR VEHICLE IN TRANSPORT 21- PARKED MOTOR VEHICLE 22- WORK ZONE MAINTENANCE EQUIPMENT 23- STRUCK BY FALLING, SHIFTING CARGO OR ANYTHING SET IN MOTION BY A MOTOR VEHICLE 24- OTHER MOVABLE OBJECT

FIRST HARMFUL EVENT 1 MOST HARMFUL EVENT 2  
 25- IMPACT ATTENUATOR / CRASH CUSHION 26- BRIDGE OVERHEAD STRUCTURE 27- BRIDGE PIER OR ABUTMENT 28- BRIDGE PARAPET 29- BRIDGE RAIL 30- GUARDRAIL FACE 31- GUARDRAIL END 32- PORTABLE BARRIER 33- MEDIAN CABLE BARRIER 34- MEDIAN GUARDRAIL BARRIER 35- MEDIAN CONCRETE BARRIER 36- MEDIAN OTHER BARRIER 37- TRAFFIC SIGN POST 38- OVERHEAD SIGN POST 39- LIGHT/UTILITY SUPPORT 40- UTILITY POLE 41- OTHER POST, POLE OR SUPPORT 42- CULVERT 43- CURB 44- DITCH 45- EMBANKMENT 46- FENCE 47- MAILBOX 48- TREE 49- FIRE HYDRANT 50- WORK ZONE MAINTENANCE EQUIPMENT 51- WALL 52- BUILDING 53- TUNNEL 54- OTHER FIXED OBJECT 59- OTHER/UNKNOWN

LOCAL REPORT NUMBER  
20240712

DAMAGE  
 DAMAGE SCALE  
 1- NONE 2- MINOR DAMAGE 3- FUNCTIONAL DAMAGE 4- DISABLING DAMAGE 9- UNKNOWN  
4

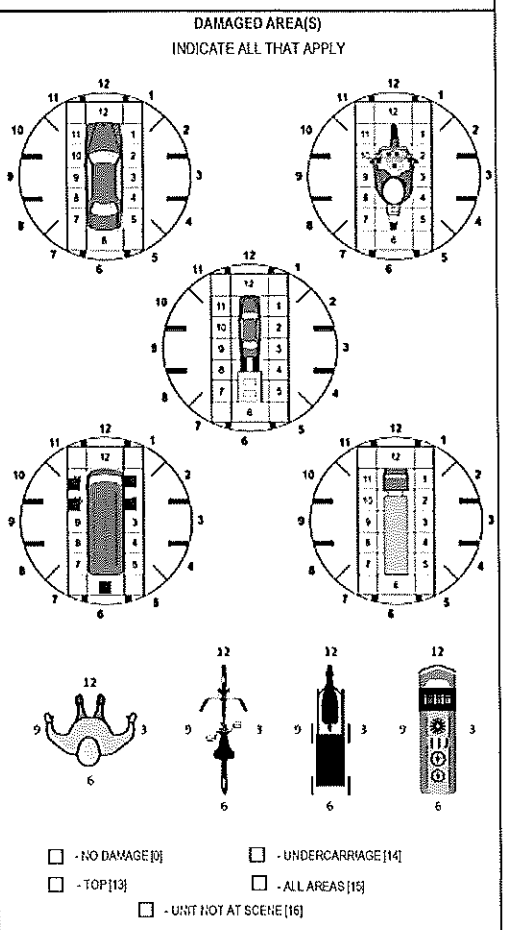

INITIAL POINT OF CONTACT  
01 0- NO DAMAGE 1-12- REFER TO UNIT DIAGRAM 13- TOP 14- UNDERCARRIAGE 15- VEHICLE NOT AT SCENE 59- UNKNOWN

TRAFFIC  
 TRAFFICWAY FLOW 1 1- ONEWAY 2- TWOWAY  
 TRAFFIC CONTROL 6 1- ROUNDABOUT 2- SIGNAL 3- FLASHER 4- STOP SIGN 5- YIELD SIGN 6- NO CONTROL  
 # OF THROUGH LANES OR ROAD 3  
 RAIL GRADE CROSSING 1 1- NOT INVOLVED 2- INVOLVED - ACTIVE CROSSING 3- INVOLVED - PASSIVE CROSSING

UNIT / NON-MOTORIST DIRECTION  
 FROM 1 TO 2  
 1- NORTH 2- SOUTH 3- EAST 4- WEST 5- NORTHEAST 6- NORTHWEST 7- SOUTHEAST 8- SOUTHWEST

UNIT SPEED 55 POSTED SPEED 55  
 DETECTED SPEED 3 1- STATED/ESTIMATED SPEED 2- CALCULATED / EDR 3- UNDETERMINED





# TRAFFIC CRASH WITNESS STATEMENT

OH-3

LOCAL REPORT NUMBER 20240712	REPORTING AGENCY KPD	DATE OF CRASH 11 16 124
---------------------------------	-------------------------	----------------------------

FOR LOCAL USE ONLY – DO NOT SUBMIT TO THE STATE EXCEPT FOR FATAL CRASHES

I, Luke Clymer HEREBY MAKE THIS VOLUNTARY STATEMENT TO

PRINTED

725 AT 77 SB @ Exit 143

OFFICER'S NAME LOCATION

A semi went to merge or just  
 jerked over so I jerked over and then  
 braked and slid over into the guard rail.

### VEHICLE INFORMATION

YEAR	MAKE	MODEL	COLOR	LIC. PLATE	STATE
2021	Ram	1500	White	PLU 5240	Ohio

ESTIMATED SPEED (MPH):	Air Bag Deployed- YES / <input checked="" type="checkbox"/> NO	SAFETY RESTRAINT USED: <input checked="" type="checkbox"/> YES / NO
------------------------	--	---

Insurance Co: <u>STATE FARM</u>	Policy: <u>9568E5479</u>
---------------------------------	--------------------------

ADDRESS OF WITNESS: <u>11499 Maryanne Dr. Sagamore Hills 44067</u>	PHONE NUMBER: <u>216-904-9594</u>
---	--------------------------------------

SIGNATURE OF WITNESS: <u>[Signature]</u>	OFFICER SIGNATURE: <u>[Signature] 725</u>
---	--