



TRAFFIC CRASH REPORT

*DENOTES MANDATORY FIELD FOR SUPPLEMENT REPORT

LOCAL REPORT NUMBER*

2020031

<input checked="" type="checkbox"/> PHOTOS TAKEN	<input checked="" type="checkbox"/> OH-2	<input checked="" type="checkbox"/> OH-3	LOCAL INFORMATION	
<input type="checkbox"/> SECONDARY CRASH	<input checked="" type="checkbox"/> OH-1P	<input type="checkbox"/> OTHER	REPORTING AGENCY NAME*	
<input type="checkbox"/> PRIVATE PROPERTY			RICHFIELD POLICE	NCIC* 07726

COUNTY* 77	LOCALITY* 3	LOCATION: CITY, VILLAGE, TOWNSHIP* RICHFIELD	HIT/SKIP 1 - SOLVED 2 - UNSOLVED	NUMBER OF UNITS 1	UNIT IN ERROR 01 98 - ANIMAL 99 - UNKNOWN
CRASH DATE / TIME* 02/27/2020 07:45			CRASH SEVERITY 5 1 - FATAL 2 - SERIOUS INJURY SUSPECTED 3 - MINOR INJURY SUSPECTED 4 - INJURY POSSIBLE 5 - PROPERTY DAMAGE ONLY		

ROUTE TYPE IR	ROUTE NUMBER 77	PREFIX	N - NORTH S - SOUTH E - EAST W - WEST	LOCATION ROAD NAME 77	ROAD TYPE HW	LATITUDE DECIMAL DEGREES 41.278030
ROUTE TYPE	ROUTE NUMBER	PREFIX	N - NORTH S - SOUTH E - EAST W - WEST	REFERENCE ROAD NAME (ROAD, MILEPOST, HOUSE #) 147	ROAD TYPE MP	LONGITUDE DECIMAL DEGREES 81.636725

REFERENCE POINT 1 - INTERSECTION 2 - MILE POST 3 - HOUSE # 2	DIRECTION FROM REFERENCE N - NORTH S - SOUTH E - EAST W - WEST S	ROUTE TYPE IR - INTERSTATE ROUTE(TP) US - FEDERAL US ROUTE SR - STATE ROUTE CR - NUMBERED COUNTY ROUTE TR - NUMBERED TOWNSHIP ROUTE	ROAD TYPE AL - ALLEY AV - AVENUE BL - BOULEVARD CR - CIRCLE CT - COURT DR - DRIVE HE - HEIGHTS	ROAD TYPE HW - HIGHWAY LA - LANE MP - MILEPOST OV - OVAL PK - PARKWAY PI - PIKE PL - PLACE	RD - ROAD SQ - SQUARE ST - STREET TE - TERRACE TL - TRAIL WA - WAY	INTERSECTION RELATED <input type="checkbox"/> WITHIN INTERSECTION OR ON APPROACH <input type="checkbox"/> WITHIN INTERCHANGE AREA NUMBER OF APPROACHES 3
DISTANCE FROM REFERENCE 200	DISTANCE UNIT OF MEASURE 1 - MILES 2 - FEET 3 - YARDS 2					ROADWAY <input checked="" type="checkbox"/> ROADWAY DIVIDED

LOCATION OF FIRST HARMFUL EVENT 1 - ON ROADWAY 2 - ON SHOULDER 3 - IN MEDIAN 4 - ON ROADSIDE 5 - ON GORE 6 - OUTSIDE TRAFFIC WAY 7 - ON RAMP 8 - OFF RAMP 1	9 - CROSSOVER 10 - DRIVEWAY/ALLEY ACCESS 11 - RAILWAY GRADE CROSSING 12 - SHARED USE PATHS OR TRAILS 13 - BIKE LANE 14 - TOLL BOOTH 99 - OTHER / UNKNOWN	MANNER OF CRASH COLLISION/IMPACT 1 - NOT COLLISION BETWEEN TWO MOTOR VEHICLES IN TRANSPORT 2 - REAR-END 3 - HEAD-ON 4 - REAR-TO-REAR 5 - BACKING 6 - ANGLE 7 - SIDESWIPE, SAME DIRECTION 8 - SIDESWIPE, OPPOSITE DIRECTION 9 - OTHER / UNKNOWN	DIRECTION OF TRAVEL N - NORTH S - SOUTH E - EAST W - WEST N	MEDIAN TYPE 1 - DIVIDED FLUSH MEDIAN (<4 FEET) 2 - DIVIDED FLUSH MEDIAN (≥4 FEET) 3 - DIVIDED, DEPRESSED MEDIAN 4 - DIVIDED, RAISED MEDIAN (ANY TYPE) 9 - OTHER/UNKNOWN 4
--	--	---	--	---

<input type="checkbox"/> WORK ZONE RELATED <input type="checkbox"/> WORKERS PRESENT <input type="checkbox"/> LAW ENFORCEMENT PRESENT <input type="checkbox"/> ACTIVE SCHOOL ZONE	WORK ZONE TYPE 1 - LANE CLOSURE 2 - LANE SHIFT/CROSSOVER 3 - WORK ON SHOULDER OR MEDIAN 4 - INTERMITTENT OR MOVING WORK 5 - OTHER	LOCATION OF CRASH IN WORK ZONE 1 - BEFORE THE 1ST WORK ZONE WARNING SIGN 2 - ADVANCE WARNING AREA 3 - TRANSITION AREA 4 - ACTIVITY AREA 5 - TERMINATION AREA	CONTOUR 2 1 - STRAIGHT LEVEL 2 - STRAIGHT GRADE 3 - CURVE LEVEL 4 - CURVE GRADE 9 - OTHER/UNKNOWN	CONDITIONS 3 1 - DRY 2 - WET 3 - SNOW 4 - ICE 5 - SAND, MUD, DIRT, OIL, GRAVEL 6 - WATER (STANDING, MOVING) 7 - SLUSH 9 - OTHER/UNKNOWN	SURFACE 2 1 - CONCRETE 2 - BLACKTOP, BITUMINOUS, ASPHALT 3 - BRICK/BLOCK 4 - SLAG, GRAVEL, STONE 5 - DIRT 9 - OTHER/UNKNOWN
---	--	---	---	--	--

LIGHT CONDITION 1 - DAYLIGHT 2 - DAWN/DUSK 3 - DARK - LIGHTED ROADWAY 4 - DARK - ROADWAY NOT LIGHTED 5 - DARK - UNKNOWN ROADWAY LIGHTING 9 - OTHER / UNKNOWN 1	WEATHER 1 - CLEAR 2 - CLOUDY 3 - FOG, SMOG, SMOKE 4 - RAIN 5 - SLEET, HAIL 6 - SNOW 7 - SEVERE CROSSWINDS 8 - BLOWING SAND, SOIL, DIRT, SNOW 9 - FREEZING RAIN OR FREEZING DRIZZLE 99 - OTHER / UNKNOWN 6
---	--

Unit 01 was traveling 77 south near milepost 147. Unit 01 stated while changing lanes he lost control of the vehicle, went off the right side of the roadway, and hit a road sign. Unit 01 came to final rest in a drainage ditch.



Indicate the north direction with an "N" on the compass diagram.

CRASH REPORTED DATE / TIME 02/27/2020 07:45	DISPATCH DATE / TIME 02/27/2020 07:47	ARRIVAL DATE / TIME 02/27/2020 07:56	SCENE CLEARED DATE / TIME 02/27/2020 08:01	REPORT TAKEN BY <input checked="" type="checkbox"/> POLICE AGENCY <input type="checkbox"/> MOTORIST
TOTAL TIME ROADWAY CLOSED 0	OTHER INVESTIGATION TIME 50	TOTAL MINUTES 64	OFFICER'S NAME* JOEL MEISTER OFFICER'S BADGE NUMBER* 722	CHECKED BY OFFICER'S NAME* DAVE POLAK CHECKED BY OFFICER'S BADGE NUMBER* 704

UNIT # 01 **OWNER NAME: LAST, FIRST, MIDDLE (SAVE AS DRIVER)**
 CAPUZZELLO JOSERPH
OWNER PHONE: INCLUDE AREA CODE (SAVE AS DRIVER)
 330-853-4506
OWNER ADDRESS: STREET, CITY, STATE, ZIP (SAVE AS DRIVER)
 477 N UNION AVE SALEM OH 44460
COMMERCIAL CARRIER: NAME, ADDRESS, CITY, STATE, ZIP
COMMERCIAL CARRIER PHONE: INCLUDE AREA CODE

LP STATE OH **LICENSE PLATE #** HCG2969 **VEHICLE IDENTIFICATION #** 1HGCR2F33HA143967 **VEHICLE YEAR** 2017 **VEHICLE MAKE** HOND
 INSURANCE VERIFIED **INSURANCE COMPANY** STATE FARM **INSURANCE POLICY #** **COLOR** WHI / **VEHICLE MODEL** ACC
 COMMERCIAL **GOVERNMENT** **IN EMERGENCY RESPONSE** **US DOT #** **TOWED BY COMPANY NAME** WORLD
 INTERLOCK DEVICE EQUIPPED **HIT/SKIP UNIT** **#OCCUPANTS** 1 **VEHICLE WEIGHT GVWR/GCWR** 1 2 - 10,001 - 26K LBS. 3 - >26K LBS. **HAZARDOUS MATERIAL**
 MATERIAL RELEASED **PLACARD**

UNIT TYPE 1 - PASSENGER CAR 7 - MOTORCYCLE 2-WHEELED 12 - GOLF CART 18 - LIMO (LIVERY VEHICLE) 23 - PEDESTRIAN / SKATER
 2 - PASSENGER VAN (MINIVAN) 8 - MOTORCYCLE 3-WHEELED 13 - SNOWMOBILE 19 - BUS (16+ PASSENGERS) 24 - WHEELCHAIR (ANY TYPE)
 3 - SPORT UTILITY VEHICLE 9 - AUTOCYCLE 14 - SINGLE UNIT TRUCK 20 - OTHER VEHICLE 25 - OTHER NON-MOTORIST
 4 - PICK UP 10 - MOPED OR MOTORIZED BICYCLE 15 - SEMI-TRACTOR 21 - HEAVY EQUIPMENT 26 - BICYCLE
 5 - CARGO VAN 11 - ALL TERRAIN VEHICLE (ATV/UTV) 16 - FARM EQUIPMENT 22 - ANIMAL WITH RIDER OR ANIMAL-DRAWN VEHICLE 27 - TRAIN
 6 - VAN (9-15 SEATS) 17 - MOTORHOME 99 - UNKNOWN OR HIT/SKIP

WAS VEHICLE OPERATING IN AUTONOMOUS MODE WHEN CRASH OCCURRED? 1 - YES 2 - NO 9 - OTHER / UNKNOWN **AUTONOMOUS MODE LEVEL** 0 - NO AUTOMATION 1 - DRIVER ASSISTANCE 2 - PARTIAL AUTOMATION 3 - CONDITIONAL AUTOMATION 4 - HIGH AUTOMATION 5 - FULL AUTOMATION 9 - UNKNOWN

SPECIAL FUNCTION 1 - NONE 6 - BUS - CHARTER/TOUR 11 - FIRE 16 - FARM 21 - MAIL CARRIER
 2 - TAXI 7 - BUS - INTERCITY 12 - MILITARY 17 - MOWING 99 - OTHER / UNKNOWN
 3 - ELECTRONIC RIDE SHARING 8 - BUS - SHUTTLE 13 - POLICE 18 - SNOW REMOVAL
 4 - SCHOOL TRANSPORT 9 - BUS - OTHER 14 - PUBLIC UTILITY 19 - TOWING
 5 - BUS - TRANSIT/COMMUTER 10 - AMBULANCE 15 - CONSTRUCTION EQUIPMENT 20 - SAFETY SERVICE PATROL

CARGO BODY TYPE 1 - NO CARGO BODY TYPE / NOT APPLICABLE 3 - VEHICLE TOWING ANOTHER MOTOR VEHICLE 5 - INTERMODAL CONTAINER CHASSIS 8 - POLE 12 - CONCRETE MIXER
 2 - BUS 4 - LOGGING 6 - CARGO VAN/ENCLOSED BOX 9 - CARGO TANK 13 - AUTO TRANSPORTER
 7 - GRAIN/CHIPS/GRAVEL 10 - FLAT BED 11 - DUMP 14 - GARBAGE/REFUSE 99 - OTHER / UNKNOWN

VEHICLE DEFECTS 1 - TURN SIGNALS 4 - BRAKES 7 - WORN OR SLICK TIRES 9 - MOTOR TROUBLE 99 - OTHER / UNKNOWN
 2 - HEAD LAMPS 5 - STEERING 8 - TRAILER EQUIPMENT DEFECTIVE 10 - DISABLED FROM PRIOR ACCIDENT
 3 - TAIL LAMPS 6 - TIRE BLOWOUT

NON-MOTORIST LOCATION AT IMPACT 1 - INTERSECTION - MARKED CROSSWALK 3 - INTERSECTION - OTHER 6 - BICYCLE LANE 9 - MEDIUM CROSSING ISLAND 12 - FIRST RESPONDER AT INCIDENT SCENE
 2 - INTERSECTION - UNMARKED CROSSWALK 4 - MIDDLEBLOCK - MARKED CROSSWALK 7 - SHOULDER / ROADSIDE 10 - DRIVEWAY ACCESS 14 - REFER TO UNIT DIAGRAM
 5 - TRAVEL LANE - OTHER LOCATION 8 - SIDEWALK 11 - SHARED USE PATHS OR TRAILS 15 - VEHICLE NOT AT SCENE
 99 - OTHER / UNKNOWN

ACTION 1 - NON-CONTACT 1 - STRAIGHT AHEAD 7 - MAKING U-TURN 13 - NEGOTIATING A CURVE 18 - APPROACHING OR LEAVING VEHICLE
 2 - NON-COLLISION 2 - BACKING 8 - ENTERING TRAFFIC LANE 14 - ENTERING OR CROSSING SPECIFIED LOCATION 19 - STANDING
 3 - STRIKING 3 - CHANGING LANES 9 - LEAVING TRAFFIC LANE 15 - WALKING, RUNNING, JOGGING, PLAYING 20 - OTHER NON-MOTORIST
 4 - STRUCK 4 - OVERTAKING/PASSING 10 - PARKED 16 - WORKING 21 - STANDING OUTSIDE DISABLED VEHICLE
 5 - BOTH STRIKING & STRUCK 5 - MAKING RIGHT TURN 11 - SLOWING OR STOPPED IN TRAFFIC 17 - PUSHING VEHICLE 99 - OTHER / UNKNOWN
 6 - MAKING LEFT TURN 12 - DRIVERLESS 18 - APPROACHING OR LEAVING VEHICLE
 9 - OTHER / UNKNOWN

CONTRIBUTING CIRCUMSTANCES 1 - NONE 7 - LEFT OF CENTER 13 - IMPROPER START FROM A PARKED POSITION 17 - VISION OBSTRUCTION 21 - LYING IN ROADWAY
 2 - FAILURE TO YIELD 8 - FOLLOWING TOO CLOSE / ACD/A 14 - OPERATING DEFECTIVE EQUIPMENT 22 - NOT DISCERNIBLE 22 - NOT DISCERNIBLE
 3 - RAN RED LIGHT 9 - IMPROPER LANE CHANGE 15 - STOPPED OR PARKED ILLEGALLY 23 - OPENING DOOR INTO ROADWAY
 4 - RAN STOP SIGN 10 - IMPROPER PASSING 16 - SWERVING TO AVOID 99 - OTHER IMPROPER ACTION
 5 - UNSAFE SPEED 11 - DROVE OFF ROAD 17 - WRONG WAY 20 - IMPROPER CROSSING
 6 - IMPROPER TURN 12 - IMPROPER BACKING

SEQUENCE OF EVENTS 1 - OVERTURN/ROLLOVER 6 - EQUIPMENT FAILURE 11 - CROSS CENTERLINE - OPPOSITE DIRECTION OF TRAVEL 16 - RAILWAY VEHICLE 22 - WORK ZONE MAINTENANCE EQUIPMENT
 2 - FIRE/EXPLOSION 7 - SEPARATION OF UNITS 12 - DOWNHILL RUNAWAY 17 - ANIMAL - FARM 23 - STRUCK BY FALLING, SHIFTING CARGO OR ANYTHING SET IN MOTION BY A MOTOR VEHICLE
 3 - IMMERSION 8 - RAN OFF ROAD RIGHT 13 - OTHER NON-COLLISION 18 - ANIMAL - DEER 24 - OTHER MOVABLE OBJECT
 4 - JACKKNIFE 9 - RAN OFF ROAD LEFT 14 - PEDESTRIAN 19 - ANIMAL - OTHER 20 - MOTOR VEHICLE IN TRANSPORT
 5 - CARGO / EQUIPMENT LOSS OR SHIFT 10 - CROSS MEDIAN 15 - PEDALCYCLE 21 - PARKED MOTOR VEHICLE

COLLISION WITH FIXED OBJECT - STRUCK 25 - IMPACT ATTENUATOR / CRASH CUSHION 31 - GUARDRAIL END 37 - TRAFFIC SIGN POST 43 - CURB 50 - WORK ZONE MAINTENANCE EQUIPMENT
 26 - BRIDGE OVERHEAD STRUCTURE 32 - PORTABLE BARRIER 38 - OVERHEAD SIGN POST 44 - DITCH 51 - WALL
 27 - BRIDGE PIER OR ABUTMENT 33 - MEDIUM CABLE BARRIER 39 - LIGHT / LUMINARIES SUPPORT 45 - EMBANKMENT 52 - BUILDING
 28 - BRIDGE PARAPET 34 - MEDIUM GUARDRAIL BARRIER 40 - UTILITY POLE 46 - FENCE 53 - TUNNEL
 29 - BRIDGE RAIL 35 - MEDIUM CONCRETE BARRIER 41 - OTHER POST, POLE OR SUPPORT 47 - MAILBOX 54 - OTHER FIXED OBJECT
 30 - GUARDRAIL FACE 36 - MEDIUM OTHER BARRIER 42 - CULVERT 48 - TREE 99 - OTHER / UNKNOWN
 49 - FIRE HYDRANT

FIRST HARMFUL EVENT 1 **MOST HARMFUL EVENT** 2

LOCAL REPORT NUMBER
 2020031

DAMAGE
DAMAGE SCALE
 4 1 - NONE 3 - FUNCTIONAL DAMAGE
 2 - MINOR DAMAGE 4 - DISABLING DAMAGE
 9 - UNKNOWN

DAMAGED AREA(S) INDICATE ALL THAT APPLY
 1 2 3 10 11 12

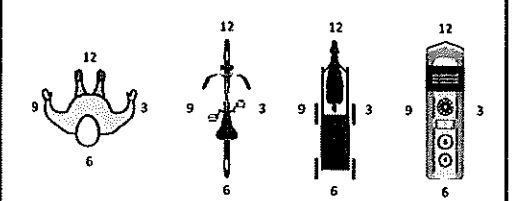
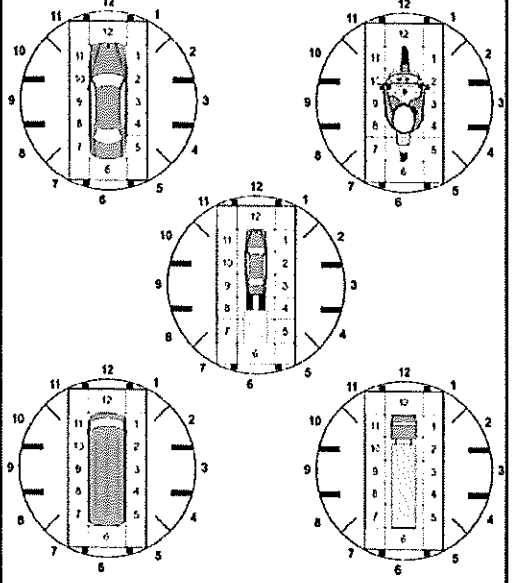

- NO DAMAGE [0] - UNDERCARRIAGE [14]
 - TOP [13] - ALL AREAS [15]
 - UNIT NOT AT SCENE [16]

INITIAL POINT OF CONTACT
 0 - NO DAMAGE 14 - UNDERCARRIAGE
 1-12 - REFER TO UNIT DIAGRAM 15 - VEHICLE NOT AT SCENE
 13 - TOP 99 - UNKNOWN

TRAFFIC
TRAFFICWAY FLOW 1 - ONE-WAY 2 - TWO-WAY
TRAFFIC CONTROL 1 - ROUNDABOUT 4 - STOP SIGN 2 - SIGNAL 5 - YIELD SIGN 3 - FLASHER 6 - NO CONTROL

OF THROUGH LANES ON ROAD 3
RAIL GRADE CROSSING 1 - NOT INVOLVED 2 - INVOLVED-ACTIVE CROSSING 3 - INVOLVED-PASSIVE CROSSING

UNIT / NON-MOTORIST DIRECTION
 FROM 1 TO 1
 1 - NORTH 5 - NORTHEAST
 2 - SOUTH 6 - NORTHWEST
 3 - EAST 7 - SOUTHEAST
 4 - WEST 8 - SOUTHWEST
 9 - OTHER / UNKNOWN

UNIT SPEED 68
POSTED SPEED 65
DETECTED SPEED 1
 1 - STATED / ESTIMATED SPEED
 2 - CALCULATED / EDR
 3 - UNDETERMINED



MOTORIST / Non-MOTORIST

LOCAL REPORT NUMBER

2020031

UNIT # 01	NAME: LAST, FIRST, MIDDLE CAPPUZZELLO JOHN STANLEY				DATE OF BIRTH 12/14/1995		AGE 24	GENDER M		
ADDRESS: STREET, CITY, STATE, ZIP 447 N UNION AVE SALEM OH 44460					CONTACT PHONE - INCLUDE AREA CODE 330-277-1473					
INJURIES 5	INJURED TAKEN BY	EMS AGENCY (NAME)	INJURED TAKEN TO: MEDICAL FACILITY (NAME, CITY)		SAFETY EQUIPMENT USED 4	<input type="checkbox"/> DOT-COMPLIANT MC HELMET	SEATING POSITION 1	AIR BAG USAGE 2	EJECTION 1	TRAPPED 1
OL STATE OH	OPERATOR LICENSE NUMBER TX569645		OFFENSE CHARGED		LOCAL CODE <input type="checkbox"/>	OFFENSE DESCRIPTION			CITATION NUMBER	
OL CLASS 4	ENDORSEMENT	RESTRICTION SELECT UP TO 3	DRIVER DISTRACTED BY 1	ALCOHOL / DRUG SUSPECTED <input type="checkbox"/> ALCOHOL <input type="checkbox"/> MARIJUANA <input type="checkbox"/> OTHER DRUG		CONDITION 1	ALCOHOL TEST STATUS: 1 TYPE: 1 VALUE: 1		DRUG TEST(S) STATUS: 1 TYPE: 1 RESULT: 1	

UNIT #	NAME: LAST, FIRST, MIDDLE				DATE OF BIRTH //		AGE	GENDER		
ADDRESS: STREET, CITY, STATE, ZIP					CONTACT PHONE - INCLUDE AREA CODE					
INJURIES	INJURED TAKEN BY	EMS AGENCY (NAME)	INJURED TAKEN TO: MEDICAL FACILITY (NAME, CITY)		SAFETY EQUIPMENT USED	<input type="checkbox"/> DOT-COMPLIANT MC HELMET	SEATING POSITION	AIR BAG USAGE	EJECTION	TRAPPED
OL STATE	OPERATOR LICENSE NUMBER		OFFENSE CHARGED		LOCAL CODE <input type="checkbox"/>	OFFENSE DESCRIPTION			CITATION NUMBER	
OL CLASS	ENDORSEMENT	RESTRICTION SELECT UP TO 3	DRIVER DISTRACTED BY	ALCOHOL / DRUG SUSPECTED <input type="checkbox"/> ALCOHOL <input type="checkbox"/> MARIJUANA <input type="checkbox"/> OTHER DRUG		CONDITION	ALCOHOL TEST STATUS: TYPE: VALUE:		DRUG TEST(S) STATUS: TYPE: RESULT: 1	

UNIT #	NAME: LAST, FIRST, MIDDLE				DATE OF BIRTH //		AGE	GENDER		
ADDRESS: STREET, CITY, STATE, ZIP					CONTACT PHONE - INCLUDE AREA CODE					
INJURIES	INJURED TAKEN BY	EMS AGENCY (NAME)	INJURED TAKEN TO: MEDICAL FACILITY (NAME, CITY)		SAFETY EQUIPMENT USED	<input type="checkbox"/> DOT-COMPLIANT MC HELMET	SEATING POSITION	AIR BAG USAGE	EJECTION	TRAPPED
OL STATE	OPERATOR LICENSE NUMBER		OFFENSE CHARGED		LOCAL CODE <input type="checkbox"/>	OFFENSE DESCRIPTION			CITATION NUMBER	
OL CLASS	ENDORSEMENT	RESTRICTION SELECT UP TO 3	DRIVER DISTRACTED BY	ALCOHOL / DRUG SUSPECTED <input type="checkbox"/> ALCOHOL <input type="checkbox"/> MARIJUANA <input type="checkbox"/> OTHER DRUG		CONDITION	ALCOHOL TEST STATUS: TYPE: VALUE:		DRUG TEST(S) STATUS: TYPE: RESULT: 1	

INJURIES	SEATING POSITION	AIR BAG	OL CLASS	OL RESTRICTION(S)	DRIVER DISTRACTION	TEST STATUS
1- FATAL	1- FRONT - LEFT SIDE (MOTORCYCLE DRIVER)	1- NOT DEPLOYED	1- CLASS A	1- ALCOHOL INTERLOCK DEVICE	1- NOT DISTRACTED	1- NONE GIVEN
2- SUSPECTED SERIOUS INJURY	2- FRONT - MIDDLE	2- DEPLOYED FRONT	2- CLASS B	2- CDL INTRASTATE ONLY	2- MANUALLY OPERATING AN ELECTRONIC COMMUNICATION DEVICE (TEXTING, TYPING, DIALING)	2- TEST REFUSED
3- SUSPECTED MINOR INJURY	3- FRONT - RIGHT SIDE	3- DEPLOYED SIDE	3- CLASS C	3- CORRECTIVE LENSES	3- TALKING ON HANDS-FREE COMMUNICATION DEVICE	3- TEST GIVEN, CONTAMINATED SAMPLE / UNUSABLE
4- POSSIBLE INJURY	4- SECOND - LEFT SIDE (MOTORCYCLE PASSENGER)	4- DEPLOYED BOTH FRONT / SIDE	4- REGULAR CLASS (OHIO = D)	4- FARM WAIVER	4- TALKING ON HAND-HELD COMMUNICATION DEVICE	4- TEST GIVEN, RESULTS KNOWN
5- NO APPARENT INJURY	5- SECOND - MIDDLE	5- NOT APPLICABLE	5- A/C MOPED ONLY	5- EXCEPT CLASS A BUS	5- OTHER ACTIVITY WITH AN ELECTRONIC DEVICE	5- TEST GIVEN, RESULTS UNKNOWN
INJURED TAKEN BY	6- SECOND - RIGHT SIDE	9- DEPLOYMENT UNKNOWN	6- NO VALID OL	6- EXCEPT CLASS A & CLASS B BUS	7- OTHER DISTRACTION	ALCOHOL TEST TYPE
1- NOT TRANSPORTED / TREATED AT SCENE	7- THIRD - LEFT SIDE (MOTORCYCLE SIDE CAR)	EJECTION	OL ENDORSEMENT	7- EXCEPT TRACTOR-TRAILER	7- OTHER DISTRACTION INSIDE THE VEHICLE	1- NONE
2- EMS	8- THIRD - MIDDLE	1- NOT EJECTED	H- HAZMAT	8- INTERMEDIATE LICENSE RESTRICTIONS	8- OTHER DISTRACTION OUTSIDE THE VEHICLE	2- BLOOD
3- POLICE	9- THIRD - RIGHT SIDE	2- PARTIALLY EJECTED	M- MOTORCYCLE	9- LEARNER'S PERMIT RESTRICTIONS	9- OTHER / UNKNOWN	3- URINE
9- OTHER / UNKNOWN	10- SLEEPER SECTION OF TRUCK CAB	3- TOTALLY EJECTED	P- PASSENGER	10- LIMITED TO DAYLIGHT ONLY	CONDITION	4- BREATH
SAFETY EQUIPMENT	11- PASSENGER IN OTHER ENCLOSED CARGO AREA (NON-TRAILING UNIT, BUS, PICK-UP WITH CAP)	4- NOT APPLICABLE	N- TAXER	11- LIMITED TO EMPLOYMENT	1- APPARENTLY NORMAL	5- OTHER
1- NONE USED	12- PASSENGER IN UNENCLOSED CARGO AREA	TRAPPED	Q- MOTOR SCOOTER	12- LIMITED - OTHER	2- PHYSICAL IMPAIRMENT	DRUG TEST TYPE
2- SHOULDER BELT ONLY USED	13- TRAILING UNIT	1- NOT TRAPPED	R- THREE-WHEEL MOTORCYCLE	13- MECHANICAL DEVICES (SPECIAL BRAKES, HAND CONTROLS, OR OTHER ADAPTIVE DEVICES)	3- EMOTIONAL (E.G., DEPRESSED, ANGRY, DISTURBED)	1- NONE
3- LAP BELT ONLY USED	14- RIDING ON VEHICLE EXTERIOR (NON-TRAILING UNIT)	2- EXTRICATED BY MECHANICAL MEANS	S- SCHOOL BUS	14- MILITARY VEHICLES ONLY	4- ILLNESS	2- BLOOD
4- SHOULDER & LAP BELT USED	15- NON-MOTORIST	3- FREED BY NON-MECHANICAL MEANS	T- DOUBLE & TRIPLE TRAILERS	15- MOTOR VEHICLES WITHOUT AIR BRAKES	5- FELL ASLEEP, FAINTED, FATIGUED, ETC.	3- URINE
5- CHILD RESTRAINT SYSTEM - FORWARD FACING	99- OTHER / UNKNOWN		X- TAXER / HAZMAT	16- OUTSIDE MIRROR	6- UNDER THE INFLUENCE OF MEDICATIONS / DRUGS / ALCOHOL	4- OTHER
6- CHILD RESTRAINT SYSTEM - REAR FACING				17- PROSTHETIC AID	9- OTHER / UNKNOWN	DRUG TEST RESULT(S)
7- BOOSTER SEAT				18- OTHER		1- AMPHETAMINES
8- HELMET USED						2- BARBITURATES
9- PROTECTIVE PADS USED (ELBOW, KNEES, ETC.)						3- BENZODIAZEPINES
10- REFLECTIVE CLOTHING						4- CANNABINOIDS
11- LIGHTING - PEDESTRIAN / BICYCLE ONLY						5- COCAINE
99- OTHER / UNKNOWN						6- OPIATES / OPIOIDS
						7- OTHER
						8- NEGATIVE RESULTS



LOCAL REPORT NUMBER 2676031	REPORTING AGENCY RICHFIELD POLICE	DATE OF CRASH M 02 D 28 Y 20
IN COUNTY OF Summit	CRASH LOCATION 77 SOUTH / I80 147MP	

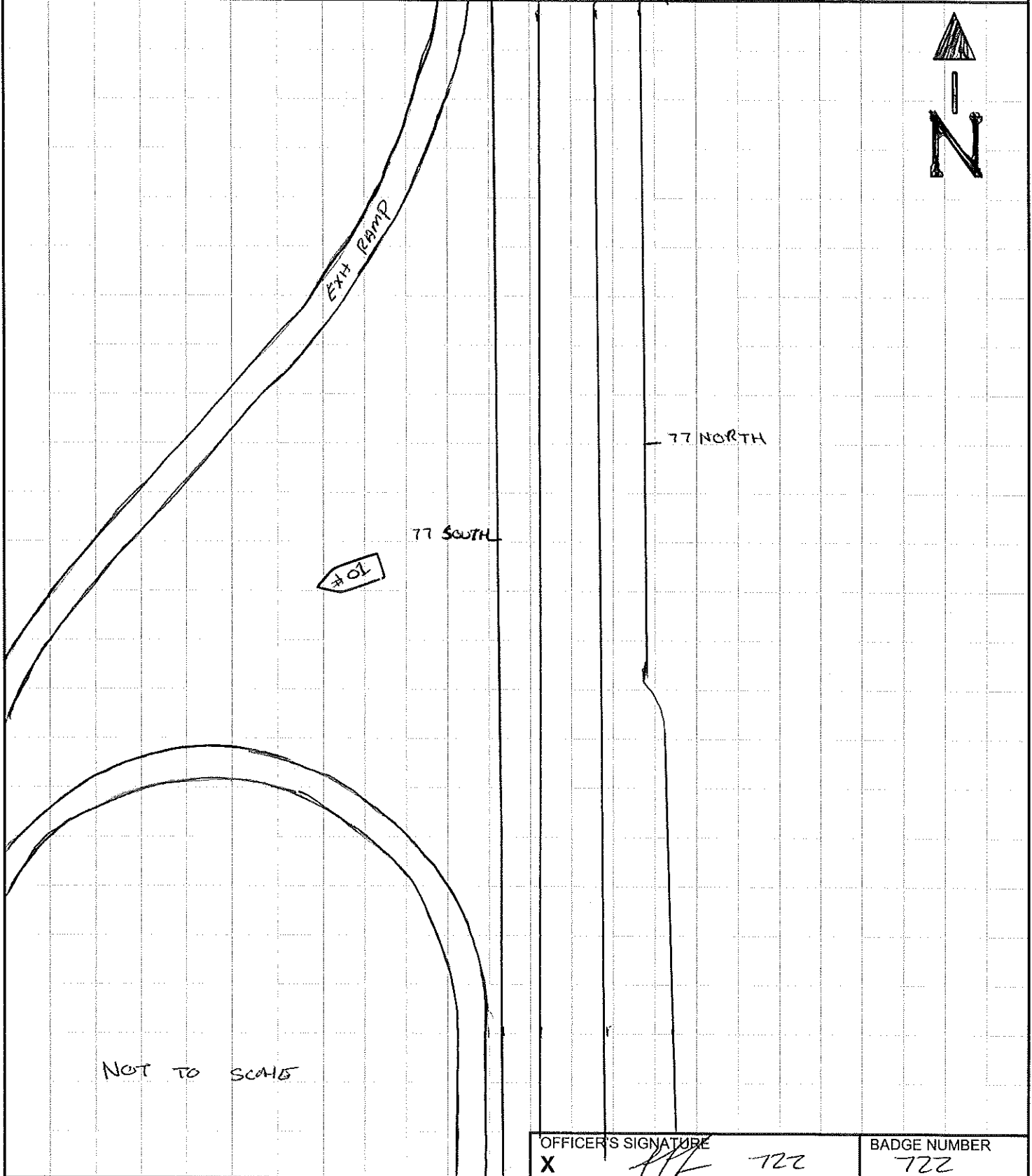

TRAFFIC CRASH WITNESS STATEMENT

LOCAL REPORT NUMBER 2020031	REPORTING AGENCY RICHLAND	DATE OF CRASH 02 27 2020
--------------------------------	------------------------------	---------------------------------

FOR LOCAL USE ONLY – DO NOT SUBMIT TO THE STATE EXCEPT FOR FATAL CRASHES

I, John Capparello PRINTED HEREBY MAKE THIS VOLUNTARY STATEMENT TO
Meister OFFICER'S NAME AT I80/77 South LOCATION 147 mp

Driving South on 77 in the left farthest lane, switched to the middle lane to slow down. Speed was approx. 68-70 mph when I hit a sheet of ice, therefore the vehicle spun out and went into grass patch and then into a ditch off the highway.

VEHICLE INFORMATION

YEAR	MAKE	MODEL	COLOR	LIC. PLATE	STATE
2017	HONDA	Accord	white	HCB-2969	OH

ESTIMATED SPEED (MPH): <u>70 mph</u>	Air Bag Deployed: <input checked="" type="radio"/> YES <input type="radio"/> NO	SAFETY RESTRAINT USED: <input checked="" type="radio"/> YES <input type="radio"/> NO
--------------------------------------	---	--

Insurance Co: <u>State Farm</u>	Policy:
---------------------------------	---------

ADDRESS OF WITNESS: <u>1300 West 9th street</u>	PHONE NUMBER: <u>330-277-1475</u>
--	--------------------------------------

SIGNATURE OF WITNESS: <u>John Capparello</u>	OFFICER SIGNATURE: <u>[Signature]</u> #422
---	---